

WAIHOPAI WARD

AREA	RESERVE	PAGE
Gorge Road	Gorge Road Recreation Reserve	2
Kapuka South	Kapuka South Recreation Reserve	4
Oteramika	Oteramika Recreation Reserve	6



File: 1117/0020

Gorge Road Recreation Reserve*Gorge Road 1***Description**

Location	Tokanui-Gorge Road Road
Classification / Status	Recreation
Area (ha)	2.0437
Legal Description	Sec 88 Blk VII Oteramika Hundred
Control	Gorge Road CDA
Previous Management Plan	No
Hierarchy	Township
Adjacent Land	The land adjacent to the reserve on the southern side is used for school and community hall purposes. On the remaining boundaries the land is farmland.
Facilities	Fenced, planting, seating.
Acquisition	In 1967 a portion of the school site was subdivided and in 1968 this land was declared a reserve for recreational purposes.

General Description

Used by the community and school for a range of organised sports and casual recreation. There has been recent (2000) improvements to the surface of the pitch. This is a particularly windy site and shelter and amenity planting has occurred recently.

Specific Policies

- Continue to maintain and develop the Gorge Road Recreation Reserve as an area of open space for organised sport and casual recreation.
- Camping is prohibited on Gorge Road Recreation Reserve as per the Camping Bylaw (2000).
- Dogs are prohibited on the Gorge Road Recreation Reserve as per the Dog Control Bylaw (1997) with the exception of the Annual Pet Day when dogs on leads are accepted.

Future Development Potential

Continue to maintain and develop the amenity and shelter planting. Native revegetation on the west and southern boundary.



Gorge Road Recreation Reserve



File: 1166/0013

Kapuka South Recreation Reserve

Kapuka 1

Description

Location	Waituna Lagoon Road
Classification / Status	Recreation
Area (ha)	3.9495
Legal Description	Sec 24 Blk XII Oteramika Hun
Control	Kapuka South Reserve Committee
Previous Management Plan	No
Hierarchy	Ward
Adjacent Land	Adjacent to the Playcentre and surrounded by farmland.
Facilities	Fencing, some riparian planting.
Acquisition	Originally this land was set aside for a school site. In 1973 the land was reserved for recreation purposes.

General Description

The bulk of this reserve is grazed. There is a small stream that bisects the reserve in two which has been fenced and where the Committee has been establishing riparian planting.

Specific Policies

- Continue to develop and maintain the Kapuka South Recreation Reserve as an area of open space for casual recreation.

Future Development Potential

Riparian planting.

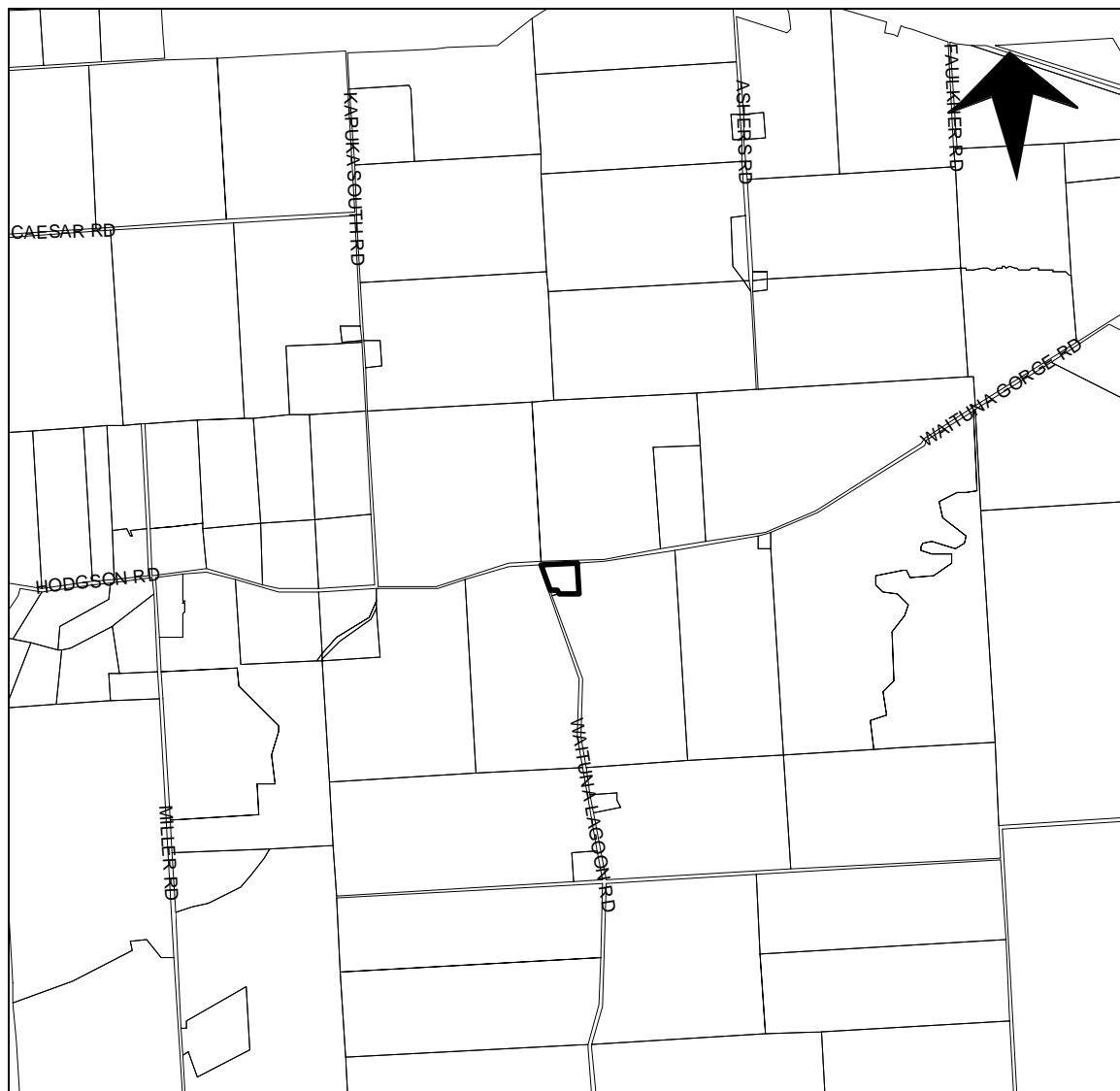

Kapuka South Recreation Reserve

File: 1191/0000

Oteramika Recreation Reserve

Oteramika 1

Description

Location	Waituna Road
Classification / Status	Recreation
Area (ha)	2.8454
Legal Description	Lot 1 DP 3625 & Lot 1 DP 3845
Control	Oteramika Reserve Committee
Previous Management Plan	No
Hierarchy	Ward
Adjacent Land	This reserve is surrounded by farmland.
Facilities	Old tennis courts, fencing, old changing shed.
Acquisition	Lot 1 DP 3625 was acquired in 1941 as a reserve for recreation purposes. Lot 1 DP 3845 was acquired in 1946.

General Description

Oteramika Recreation Reserve, on the corner of Waituna and Kapuka North Roads and adjacent to the Oteramika Hall site. The land contains what appears to be old rugby fields currently grazed and old tennis courts in need of repair.

Specific Policies

- Continue to maintain the Oteramika Recreation Reserve as an area of open space for casual recreation.

Future Development Potential

Status quo.



Oteramika Recreation Reserve